

We're proud to be **Humble ISD**

Parents/Community | Enrollment | Employees | Employment | Site Map/Search | Contact Us

Quick Links

Campus Sites

Departments

Announcements

**Your Schools Insider** community!

Important Account Information

Welcome to Humble ISD's ***Your Schools Insider***. This is an online communication tool for the district to -

**Notify you** in case of an emergency that might affect students in our schools  
**Keep you informed** about important goings-on within Humble ISD  
**Respond to your questions** and concerns, and  
**Get your input** on where we're going as a district.

For us to be most effective in communicating with you, we ask that you

★ Keep your contact details, school relationship and information preferences up to date by clicking the Login/My Account button on the Welcome page and updating your profile. If you do not have an account, you can sign up on the login page.

★ If you attempt to set up a new account and receive the message that your email address is already in the system, you should click the button EMAIL PASSWORD. The system has been preloaded with any email address you may have provided in the online student update or registration procedures.

★ **Important for parents to know:** Updating your information here does not automatically update it with your child's teachers. If you have a change, such as a new cell phone number, you will want to make the change here in order to receive school-wide emergency notifications AND in the online Student Information Update page that schools use to contact parents individually.

Questions? Contact Us!

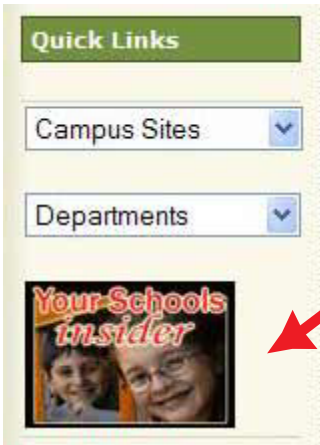

Go to the Humble ISD web site at [www.humble.k12.tx.us](http://www.humble.k12.tx.us)  
Click on this button to log in to Your Schools Insider !

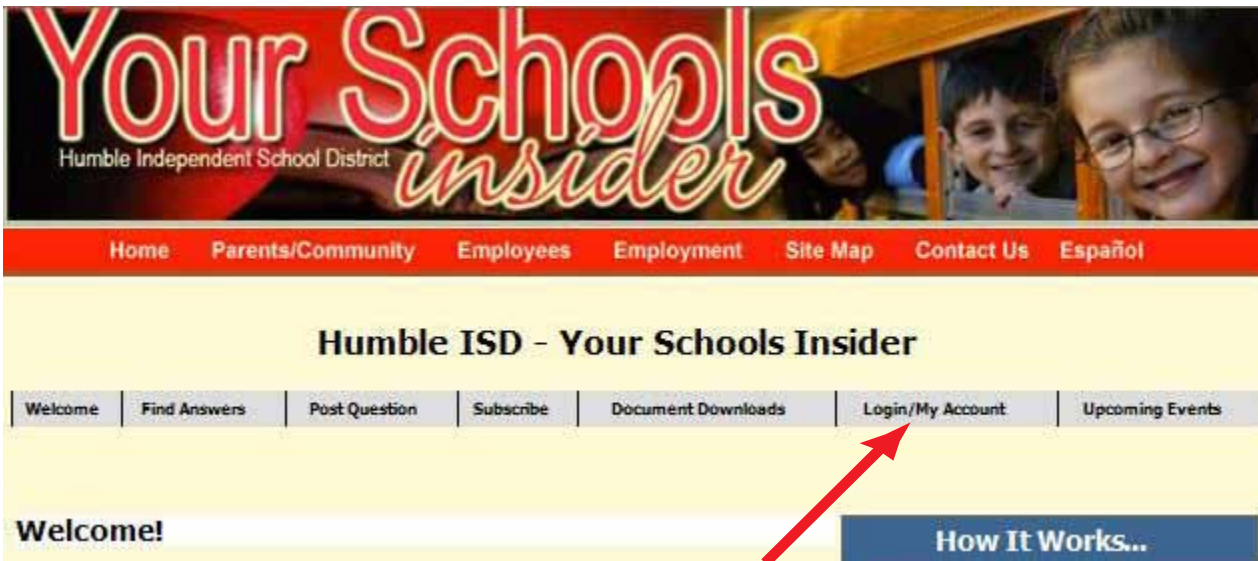

On the Welcome page, you'll see information about how to use the system. Click the **LOGIN/MY ACCOUNT** button to set up or change your account information.

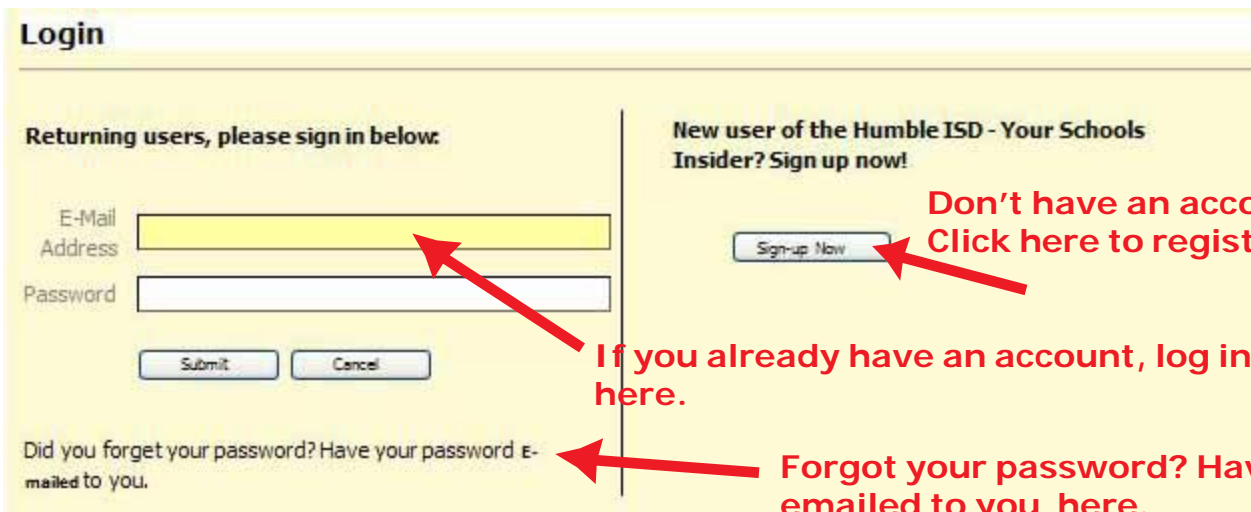

To set up your account, follow these easy steps.

## STEP 1

To login to Humble ISD - Your Schools Insider in the future you will use your email address and a password, which you can change after you login to the system:

Enter a valid email address and select a password

Login Information	
E-mail Address:	<input type="text"/>
Password:	<input type="password"/>
Confirm Password:	<input type="password"/>

**TIP:** You may sign up under several different email accounts; however, only the email address and main contact numbers on file here will be used for emergency alerts and announcements.

## STEP 2

Please provide your contact details so we can send you information that matches your preferences.

Enter more details about your contact information

Your Contact Details	
First Name: (Legal Name - e.g. Joseph, not Joe)	<input type="text"/>
Middle Name or Initial:	<input type="text"/>
Last Name:	<input type="text"/>
Home Phone	<input type="text"/>
Work Phone	<input type="text"/>
Mobile Phone	<input type="text"/>
Address:	<input type="text"/>
City:	<input type="text"/>
State:	<input type="text"/>
Zip Code:	<input type="text"/>

**NOTE:** Telephone numbers and email addresses entered here will be used by the YS Insider system to notify parents/guardians in the event of a district-wide emergency.

Select each school and the relationship to that school which applies to you. You can define multiple relationships to an individual school and relationships to multiple schools.

## STEP 3

**Your Relationships To Our Schools**

Available Items

- Atascocita High
- Atascocita Middle
- Bear Branch
- CATE

Available Items

- Parent/Guardian

Add Item(s)

Remove Item(s)

Selected Items

Prev Next Cancel

**Choose schools and relationships**

**Example:** You are the parent of a student at *Bear Branch*, you teach at *Creekwood Middle*, and you are interested in hearing about news at Kingwood and/or Kingwood Park high schools because you enjoy going to local high school drama and musical performances. In this case, you would select:

BEAR BRANCH - PARENT/GUARDIAN  
CREEKWOOD - EMPLOYEE  
KINGWOOD HIGH - COMMUNITY MEMBER  
KINGWOOD PARK HIGH - COMMUNITY MEMBER

Select the interest groups that you want to subscribe to and receive email notification when we publish a newsletter or notice for that interest group.

## STEP 4

**Your Areas of Interest**

Available Items

- Board meeting highlights
- Humble ISD Alert Notices
- News Releases

Add Item(s)

Remove Item(s)

Selected Items

Prev Next Cancel

**Choose from a list of interest areas**

**Humble Independent School District** 20200 Eastway Village Drive, P.O. Box 2000, Humble, TX 77347-2000  
Tel. 281-641-1000, FAX 281-641-1050  
Dr. Guy M. Sconzo, Superintendent

You only receive the announcements and news you care about. This selection is optional, and other categories will be added as they are developed.

Select the knowledgebase categories that you want to subscribe to so you can track the discussion between the district and our community on a specific topic. You will receive email notification when a new FAQ is added to your categories.

**STEP 5**

**Your Knowledgebase Categories**

Available Items		Selected Items
Academics	<input type="button" value="Add Item(s)"/>	
Athletics		
Board Meeting Highlights	<input type="button" value="Remove Item(s)"/>	
Bond Updates		
Employment		
Fact or Fiction		
Finance		
Miscellaneous		
Schools Humble		
Website Questions		

You can be notified of updates in your areas of interest

**Humble Independent School District**

20200 Eastway Village Drive; P.O. Box 2000; Humble, TX 77347-2000  
Tel. 281-641-1000; FAX 281-641-1050  
Dr. Guy M. Sconzo, Superintendent

Track discussion between the district and community on a specific topic. This selection is optional, and other category choices will be added as they are developed.

## Humble ISD - Your Schools Insider

Thank you for signing up as a user of Humble ISD. You should receive a registration confirmation message at the email address you signed up with. In the future you can login to this site, with your email and password, to update your contact details, school relationships or information preferences. You can also deactivate your account so that you receive no future electronic communication from Humble ISD.

## STEP 6

That's all there is to it!  
You can change your preferences at any time.

**Humble Independent School District**

20200 Eastway Village Drive; P.O. Box 2000; Humble, TX 77347-2000  
Tel. 281-641-1000; FAX 281-641-1050  
Dr. Guy M. Sconzo, Superintendent

After you click Continue, a confirmation email is on its way to the address you provided.

### Remember!

Be sure to allow email from this sender so your communications won't end up in your Junk Mail folder and keep your contact information up to date so you won't miss any news!